



1 FRONT ELEVATION



3 RIGHT ELEVATION

COLOR SCHEME KEY

- 1 MAIN SW 7757 HIGH REFLECTIVE WHITE
- 2 TRIMS SW 7631 CITY LOFT
- 3 DETAIL COLOR SW 7014 EIDER WHITE
- 4 SHUTTERS SW 6766 MARINER
- 5 AWNING/BRACKETS SW 9183 DARK CLOVE
- 6 RAILINGS/WINDOWS/DOOR FRAMES SW 7048 URBANE BRONZE
- 7 ROOFS BARREL TILES REDDISH ORANGE
- 8 STONE VENEER FRENCH LIMESTONE CREAM

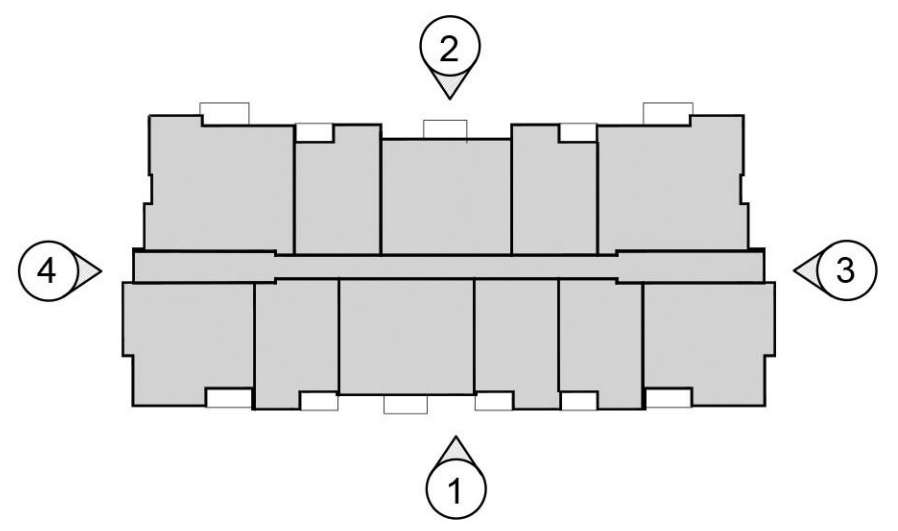

KEYPLAN
N.T.S.
BLDG IA ELEVATIONS

SCALE: 1/8"=1'-0"
PZ23-12000017
06-25-2025

PRE-APP MEETING 04/04/2023
DRC SUBMITTAL 06/13/2023
DRC RE-SUBMITTAL 08/16/2023
DRC RE-SUBMITTAL 01/01/2024
DRC RE-SUBMITTAL 10/16/2024
DRC RE-SUBMITTAL 12/10/2024
DRC RE-SUBMITTAL 01/29/2025

BY

OAKS @ PALM AIRE
FOR:
MORGUARD
LOCATED AT:
POMPANO BEACH, FLORIDA

STATE OF FLORIDA
JOSE L. SAUMWELL
AR0013085

MSA ARCHITECTS, INC.
AAC0000895
8850 SW 74th COURT
SUITE 817
MIAMI, FLORIDA 33156
(305) 273-9911

MSA ARCHITECTS
ARCHITECTURE & PLANNING

COPYRIGHT © 2022 MSA ARCHITECTS, INC. THE ARCHITECTURAL DESIGN AND DETAIL DRAWINGS FOR THIS BUILDING AND/OR OVERALL PROJECT ARE THE LEGAL PROPERTY OF AND ALL RIGHTS ARE RESERVED BY THE ARCHITECT. THEIR USE FOR REPRODUCTION, CONSTRUCTION, OR DISTRIBUTION IS PROHIBITED UNLESS AUTHORIZED IN WRITING BY THE ARCHITECT.

DRAWN JAV
CONTRACT DATE 10/12/22
SCALE AS SHOWN
JOB NO. 2181.PRJ
SHEET TITLE:
BLDG ELEVATIONS
SHEET NUMBER:
A-3.1.1A